

USING DOUBLE BEAD TIPS

Bead tips are used as an easy and secure way of attaching a clasp to a length of strung beads. They come in 2 basic styles ,single and double.

Cut the bead cord to 2 1/2 times the length of your project. For example, if you were stringing a 16" necklace then cut a 40" piece of bead cord.

1. Thread the bead cord through the eye of the needle and take both ends of the cord and tie a knot. Now thread the needle & cord through the bead tip so that the knot is resting inside the cup of the bead tip, between the two clam shell halves. Brush the knot in the bead tip with either gum arabic, cement, or clear nail polish. When the knot is dry trim the tails of cord close to the knot.

2. Push the two clam shell halves together forming a ball, which will hide the knot.

3. Place one half of the clasp on the hook of the bead tip. Grasping the tip of the hook with a needle nose plier, roll it shut.

4. String on all your beads. Now string on a bead tip. Cut the bead cord near the needle, you'll now have two pieces of cord in your hands, tie a simple knot and pull it into the cup of the bead tip. Glue the knot as in step 1. Attach the other end of the clasp and repeat steps 2 and 3.

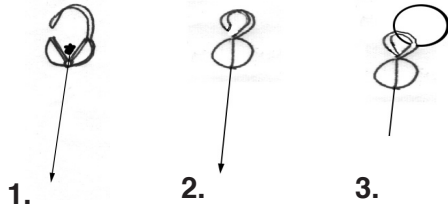

Helpful hints using

Headpins, Eyepins,
Beading Wire, Crimp
Beads & Bead Tips

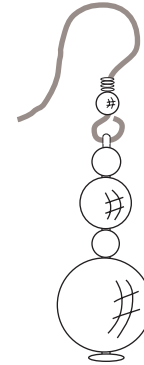

Rock Garden
17 South Main Street
Branford, CT. 06405
(203) 488-6699
www.rockgarden.com

Mon. - Fri. 11am - 7pm
Saturday 10am - 6pm

EARRINGS, PENDANTS & CHARMS

Head pins are like a straight pin, but without the sharp point. Sizes range from 1" to 4" in length, and thin and thick in diameter (Please Note: gemstone beads tend to have small holes, do not force them onto a headpin or they may break!). They are used to make earrings, pendants, necklace links, and charms from most any drilled Bead. Two basic tools are required, a round-nose plier (to form the loop), and a wire cutter (to cut the pin to size).

1. A head pin.

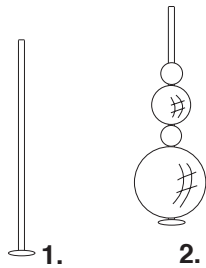

2. Stack beads onto the head pin. Combinations of most any shape or size can be used, be creative! Cut the top of the head pin so that only 1/4" of bare pin remains.

3. Grasp the tip of the head pin with the round nose plier. Firmly hold and roll the wire away from you, forming a circle. The size of the loop depends on where the tip of the head pin is placed in the plier. For a small loop, place the tip of the head pin near the tip of the plier. For larger loops, move away from the plier tip. Attach the loop to an ear finding (ear wire) or other suitable finding, or thread onto a necklace.

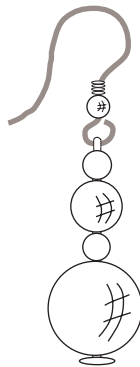
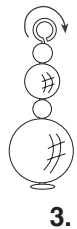

EYE PINS

An eye pin is similar to a head pin, instead of having a head at its bottom it has a loop in which charms or other dangles can be attached. Beads are stacked on the pin and a loop is formed just like in the above example.

USING BEADING WIRE & CRIMP BEADS

Beading Wire is a steel cable that has been coated with nylon, it's extremely strong and is used to make bracelets, anklets and necklaces. It comes in various weights, .010 being the lightest and .024 the heaviest. Choose a size that best suits your beads. For example, small beads (4mm) would use .010 Beading Wire, while larger beads (6mm) .014, and heavy beads (9mm+) .019 or .024 Beading Wire. Crimp Beads will be used to secure clasps to the Wire. There are many sizes and styles of crimp beads, as well as many types of Beading Wire, such as Acculon™, Beadalon®, Jewelry Wire®, Soft Flex™ and Soft Touch™.

Cut the Beading Wire to length plus 6". For example, if you were stringing a 16" necklace then cut a 22" piece of tigertail.

1. Take one end of the Beading Wire and pass it through a crimp bead. Leave a 2" tail.
2. Pass the tail through one end of the clasp and then back through the crimp bead.
3. Crimp or crush the crimp bead with a needlenose plier. You want the crimp bead to be flattened. Now string on one bead over both pieces of Beading Wire. It will help if you pick out two to six beads with the largest holes before you begin stringing, these will be the first and last beads strung.
4. String on another crimp bead over both pieces of Beading Wire and crimp. The tail extending from the second crimp can be cut off, or left on and strung over with other beads.

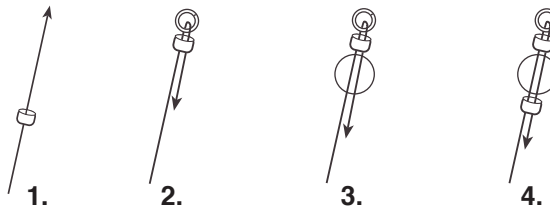

5. String on all your beads except one, remember to use two or three beads with the largest holes for the end. String on a crimp bead but don't crimp it yet.
6. String on your last bead and another crimp bead.
7. Pass the tail through the other end of the clasp (see step 2), and then back through the first crimp bead, the last bead, and the second crimp bead. Pull the tail so there are no large gaps in the necklace (1/4" gap is fine), and crimp both crimp beads.

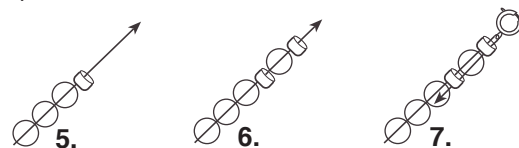

BASIC STRINGING USING A NEEDLE, CORD & BEAD TIPS

Basic stringing involves using a beading needle and bead cord, and is quite simple. The bead cord is passed through the eye of a flexible beading needle, a clasp is attached using a bead tip, and the beads are strung on over the needle and pushed down the cord towards the clasp.

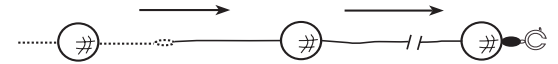

Beading needles are flexible and are usually made of twisted brass or steel wire with a large eye. The eye will collapse when a bead or finding is strung over it. They come in a variety of thicknesses and lengths. Generally the steel needles hold up better than the brass needles. If you are careful, you will get many uses from a needle.

USING SINGLE BEAD TIPS

Bead tips are used as an easy and secure way of attaching a clasp to a length of strung beads. They come in 2 basic styles (single and double), and in various metals.

Cut the bead cord to 2 1/2 times the length of your project. For example, if you were stringing a 16" necklace then cut a 40" piece of bead cord.

1. Thread the bead cord through the eye of the needle and take both ends of the cord and tie a knot. Now thread the needle & cord through the bead tip so that the knot is resting inside the cup of the bead tip. Brush the knot in the bead tip with either gum arabic, cement, or clear nail polish. When the knot is dry trim the tails of cord close to the knot.
2. Place one half of the clasp on the hook of the bead tip. Grasping the tip of the hook with a needle nose plier, roll it shut.
3. String on all your beads. Now string on a bead tip as shown in figure 3. Cut the bead cord near the needle, you'll now have two pieces of cord in your hands, tie a simple knot and pull it into the cup of the bead tip. Glue the knot as in step 1. Attach the other end of the clasp and repeat step 2.

